

NIPISSING

U N I V E R S I T Y

MATURE / TRANSFER STUDENT GUIDE 2020

Right where
you belong



Focus on Success

Helping you prepare for the future

Earn a first-rate education at Nipissing University, recognized as having the **top student support services** among universities in Canada.

Learn within an **inclusive** and **friendly** atmosphere.

Enjoy access to **supportive professors**.

Experience ample **hands-on learning** opportunities, and if you're interested, the chance to assist with **faculty research** as an undergraduate student.

Our priority is to offer as much help as possible by applying the credits you've already earned through university or college to an undergraduate or professional degree program, offering flexible full and part-time studies, and delivering collaborative, on-site, online, and blended programs that fit into your location and schedule.



#1 in
RESIDENCE LIVING
among universities
in Canada
– Maclean's 2019

#1 in
**MENTAL HEALTH
SERVICES**
among universities
in Canada
– Maclean's 2019

TOP FIVE
STUDENT LIFE STAFF
in Canada
– Maclean's 2019

The NU Promise

The first initiative of its kind in an Ontario university, our promise further enhances Nipissing's focus on our students' success.

The current rate of employment for Nipissing graduates is already above the provincial average, but our promise further demonstrates the University's confidence in the quality of programming, teaching, career development and overall student experience.

If you have not secured career-related employment 6 months after completing your undergraduate degree, Nipissing invites you to return for another year, tuition-free for up to 30 additional credits.

For details visit: nipissingu.ca/nupromise

Over
90%

of Nipissing students
find employment within
6 months of graduating
compared to the Ontario
University average
of 86.98%

TOP FIVE
in STUDENT
SATISFACTION

among primarily undergraduate
Ontario universities
— Maclean's 2019



About North Bay	2	Campus Map	18	College Transfer Policies	30
Campus Community	4	Program Options	20	Other Transfer Policies	36
Student Support	6	Other Pathways to a Degree	22	Concurrent Education	
Student Union	11	Experiential Learning	23	Admission Requirements	38
Athletics	12	Schulich School of Education	24	Application Deadlines	39
Residence	14	Degree Diploma Programs	26	Checklist	40
Off Campus Living	15	Applying to Nipissing	28		
Financial Planning	16	Transferring from University/College	29		

City with a View

The University is situated on the traditional territory of Nipissing First Nation, and within the Robinson-Huron Treaty of 1850. We also acknowledge the nearby Anishnabek communities of Dokis First Nation and Temagami First Nation.

The City of North Bay, Ontario, is nestled between Lake Nipissing and Trout Lake and is surrounded by numerous protected natural areas, heritage forest parks and historical sites. Approximately a 3 ½ hour drive or a quick 45 minute flight from either Toronto or Ottawa, our friendly and inviting city is a popular year round destination. Offering plenty of activities, amenities, and services to meet your student needs, North Bay's vibrancy is only exceeded by its hospitality.

North Bay Recreation

In addition to the activities available to you on campus, North Bay offers so much more:

- YMCA with pool
- Arenas (Memorial Gardens hosts our local OHL team, the Battalion)
- Downhill ski and snowboarding hill (1 right in town, and a 2nd within a 45 minute drive)
- Nordic ski clubs
- Biking paths and walking trails
- Golf courses
- Tennis courts
- Public beaches ideal for swimming and canoeing
- Capitol Centre (features theatre performances and concerts)
- Art galleries
- North Bay Museum
- Community festivals and events

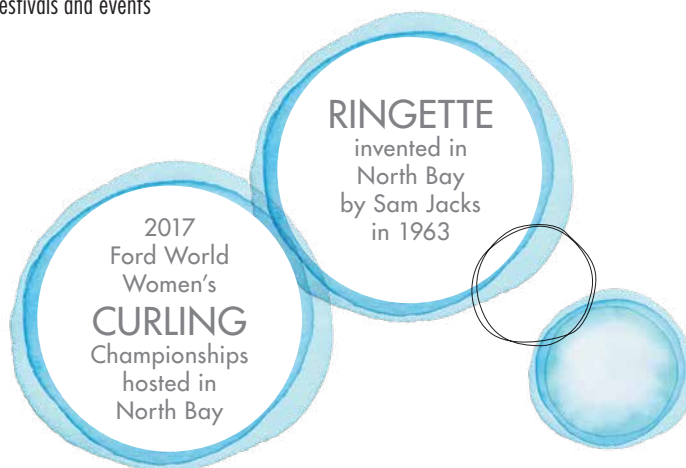

North Bay at a glance: cityofnorthbay.ca

ski hill and terrain park within city limits



17.5 km

of paved multi-use trails
throughout the city

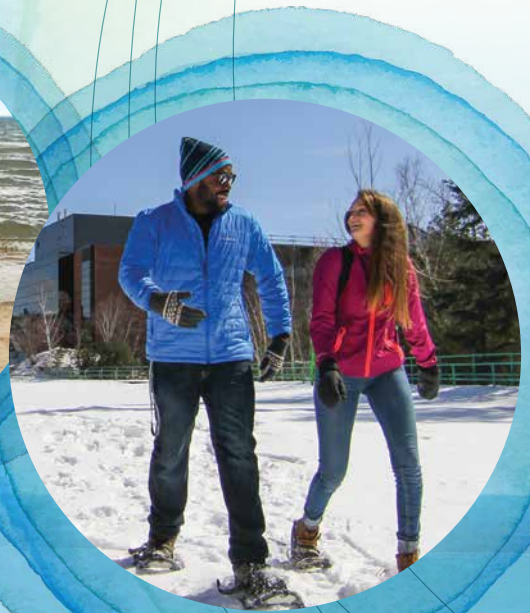

Your Campus Community

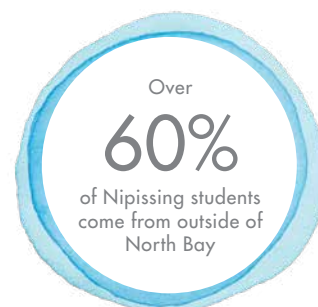

Nipissing offers you a friendly campus and a commitment to providing one of the best undergraduate experiences among universities in Canada. Enjoy access to supportive professors, learn within small class sizes, have ample opportunity to get involved, and explore your interests. You will decide what shape your life will take, and will have access to all the academic, financial, and personal support systems you need.

Due to the generous contributions of our donors, the multi-use turf field meets FIFA standards and is located adjacent to the Robert J. Surtees Athletics Centre.

Located in the heart of campus, the Harris Learning Library features naturally lit and large open spaces for studying, collaborating and connecting.



*The new Student Centre
is set to open in 2020.*

*Everyone is welcome to attend and participate
in the annual Powwow in September.
Celebrate and share Indigenous
culture and the diversity of
our community.*

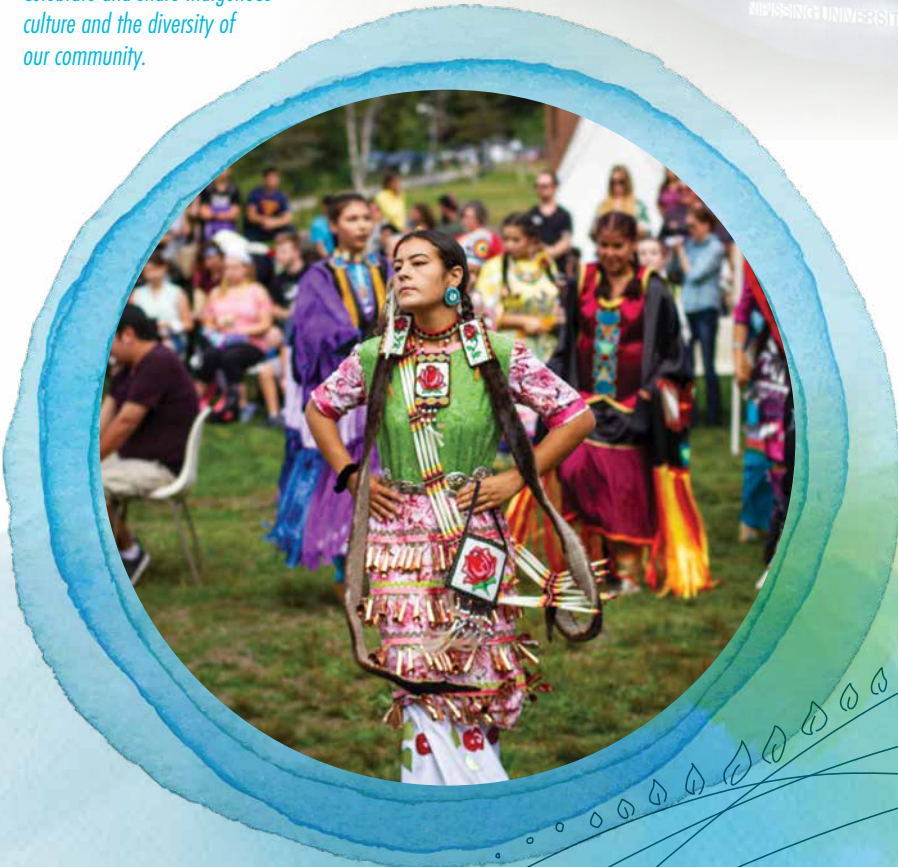

Campus sits on
**720
acres**
of Canadian Shield
forest

20 km
of hiking/Nordic ski
trails on campus

Student Support

#1 in
STUDENT SERVICES
among universities
in Canada
– Maclean's 2019

TOP FIVE
in **STUDENT
SATISFACTION**
in primarily undergraduate
universities in Canada
– Maclean's 2019

You can count on our support – academically, culturally, financially, and personally.
Student Development and Services is an excellent resource that will help you maximize your success.

The Mature and Transfer Student Network

The Mature and Transfer Student Network is a transition program that supports mature students, college transfer students, university transfer students, and second-degree students as they complete their studies at Nipissing University.

As a member of the network, you will have the option to participate in workshops, day trips, and family-friendly programming where you can connect with other mature, transfer, and second-degree students. You also have access to a professional staff member for appointments to help support you as you transition to academic and social life on campus. Interested participants are encouraged to keep an eye on their student email account for monthly invitations to events and workshops.

Student Experience Coordinator, Transfer Student Success:

maturetransfer@nipissingu.ca

(705) 474-3450 ext. 4151

Academic Advising

nipissingu.ca/academicadvising

Our primary focus is to enhance your learning experience and development.

We will help you to:

- explore academic opportunities;
- address difficulties; and
- make the best informed and responsible decisions regarding your academic programs, priorities and goals.

For more information, visit nipissingu.ca/academicadvising



Accessibility Services

Email: sas@nipissingu.ca
nipissingu.ca/sas

Student Accessibility Services assists students with permanent or temporary disabilities. If you have (or suspect that you have) a disability, we encourage you to contact us to ask about test and exam accommodation, distraction-reduced working and testing areas, note-taking support, adaptive technology and assistive software, alternate format reading materials, and counselling or tutorial support.

Equity Centre

Email: equitycentrenu@nipissingu.ca
705-474-3450 ext. 4213

The Equity Centre is a student-run safe space on campus where students can hang out, learn, or help organize events and campaigns that raise awareness of equity issues which impact the diverse communities at Nipissing University. They provide education and resources, advocate on behalf of students, and promote allyship on campus. The Equity Centre and our events are open to everyone.

Enji giigdoyang – The Office of Indigenous Initiatives

Email: indigenousprograms@nipissingu.ca
nipissingu.ca/indigenous

We welcome Indigenous peoples within inclusive and intergenerational programs in the Office of Indigenous Initiatives. In the Nipissing dialect of Anishnaabemwin, Enji giigdoyang means, “where we come to meet and talk about things.”

- Enji giigdoyang Student Lounge
- Indigenous Week and Enji giigdoyang Speaker Series
- Visiting Elders
- Experiential Learning Opportunities
- Academic, Personal, and Cultural Supports
- Mentorship Programming





*Travel abroad with one of
our 16 partner schools*

International Initiatives

Email: myinternational@nipissingu.ca
nipissingu.ca/international

Study abroad or internationalize your degree at home. We offer support services and programs to assist with intercultural development and integration, creating experiences that foster global citizenship. Upper year students enjoy our exchange partnerships with Australia, Barbados, China, Finland, France, Germany, India, Ireland, Japan, Netherlands, Norway, South Africa, South Korea, Sweden, United Kingdom, and the United States.

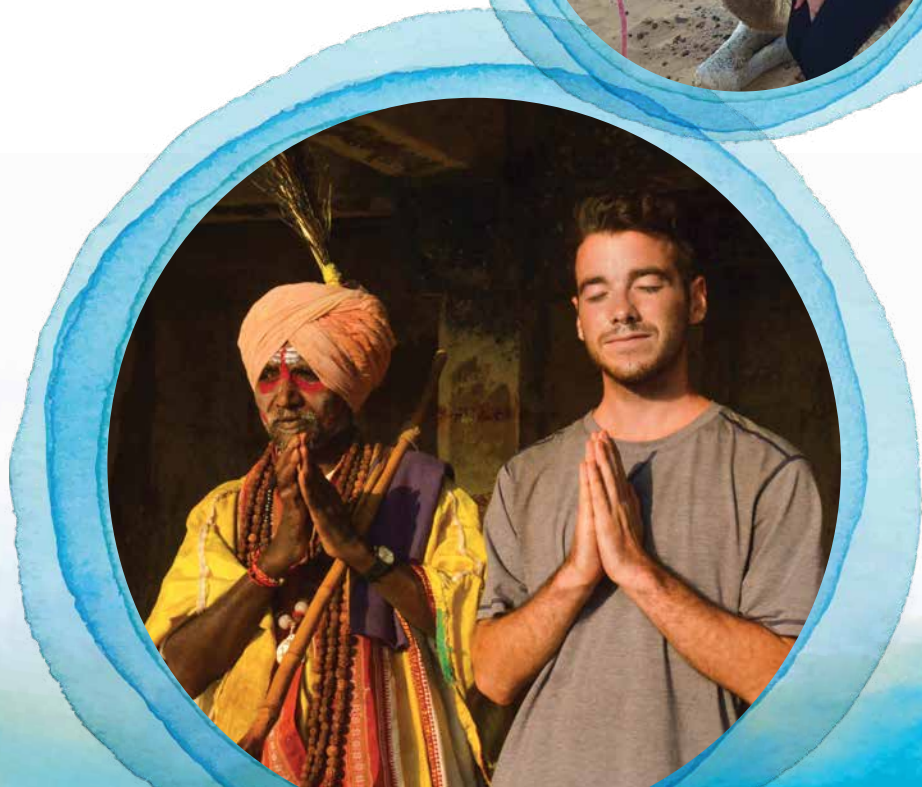

Health Centre

nipissingu.ca/healthcentre
705-474-7600 ext. 5261

A medical team is in attendance at the Campus Health Centre and available to all students Monday to Friday. The Campus Health Centre provides quality services and health care delivery by a licensed physician and nurses.

Multi-Faith Space

Room H340

With a diverse community studying and working at Nipissing, the university has developed the Multi-Faith Space, offering an inclusive space on campus for people to practice all religions. The purposeful absence of any religious icons, symbols, or resources creates a neutral environment so individuals can use the space as a safe and comfortable place for prayer, meditation and reflection.

Sexual Violence Prevention and Education

Email: svsupport@nipissingu.ca
nipissingu.ca/sexualviolence

Nipissing University is committed to creating and maintaining a safe environment for all students. Services for survivors include: navigation of services on and off campus, assistance with arranging academic accommodations, and help understanding reporting options. Additionally, there are free workshops on consent, healthy relationships, and bystander intervention for all students.

Student Counselling

Email: counselling@nipissingu.ca
nipissingu.ca/counselling

Student Counselling Services offers free personal counselling services, specialized therapeutic groups, referral services, and wellness events to all students. We endeavor to do all we can to help students succeed in their academic and personal lives.



Student Intervention Support

Email: sis@nipissingu.ca
nipissingu.ca/nuperspective

This support is offered to students who may be experiencing difficulty accessing the appropriate services, require a referral to services, require further collaboration within their current support services, or need assistance transitioning to or from the University (e.g. returning after being admitted to the hospital, registering again after withdrawing for mental health reasons, etc.). The relationship between the SIS staff and the student is collaborative, goal-oriented, supportive, and voluntary.

Student Learning and Transitions

Email: slt@nipissingu.ca
nipissingu.ca/slt

Student Learning and Transitions (SLT) supports students' academic and personal success from orientation to graduation. These may include one-on-one consultations, group workshops or tutorials, peer-to-peer support and tutoring, or referral services. SLT's transition programs seek to ease the multiple transitions that occur throughout a student's post-secondary experience, including those who have entered through non-traditional pathways and include facilitated programs, campus activities, and events that promote academic and social integration into the Nipissing University Lakers' community.

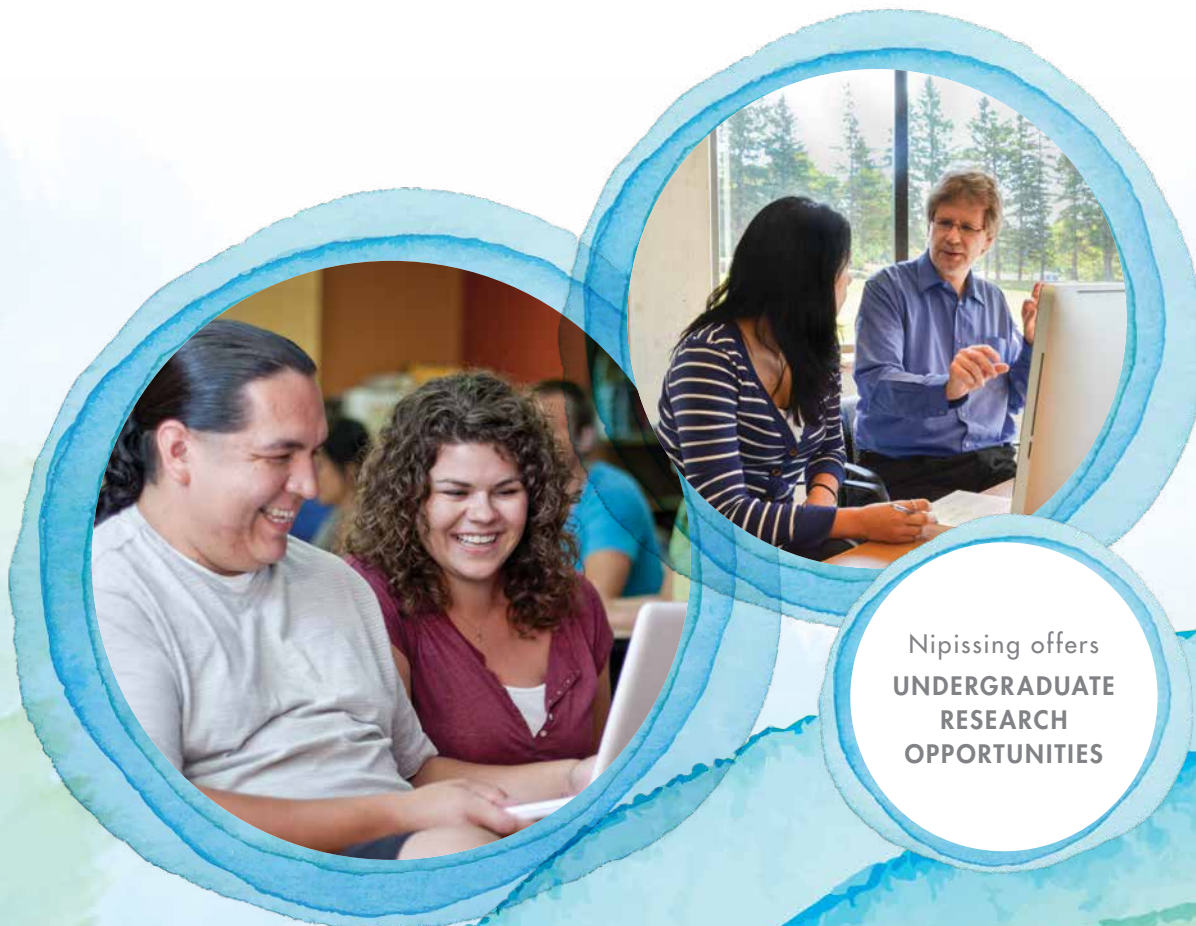

Student Union (NUSU)

Email: info@nusu.com

Telephone: (705) 474-3450 ext. 4801

Website: nusu.com

Social Media: @NUSUtalks – Facebook, Instagram and Twitter



The Nipissing University Student Union (NUSU) is a body comprised of all Nipissing University students, representing approximately 5000 members on campus in North Bay and long-distance students. Collectively, students have a much stronger voice, and NUSU is the embodiment of this voice. The organization strives to represent students democratically, provide a communication framework, and lobby for legislative change on issues that affect students. As an elected board, NUSU Executives and Directors provide a full range of services (financial and academic), activities, events, and political advocacy to improve the student experience including:

- Health and Dental Plan
- Community Involvement
- Food Bank
- Clubs
- Career Services
- Frosh Week & Shine Day



Nipissing alumni
live in
58 countries
and are available
to mentor current
students through NU's
career networking
platform.



Student Athletics Centre

Whether you are a gym enthusiast or a weekend warrior, Nipissing has just what you need. Oh, and put your wallet away because access to the R.J. Surtees Student Athletics Centre is included in your student fees! Our facility features:

- 3 gymnasiums
- 2 international squash courts
- Fitness centre with weekly fitness classes in a variety of disciplines
- Cardio studio
- Weight room
- Turf field
- 20 km of hiking and snowshoe trails
- Groomed Nordic ski trails
- Natural waterfall right on campus

*Women's soccer on
the new turf field*

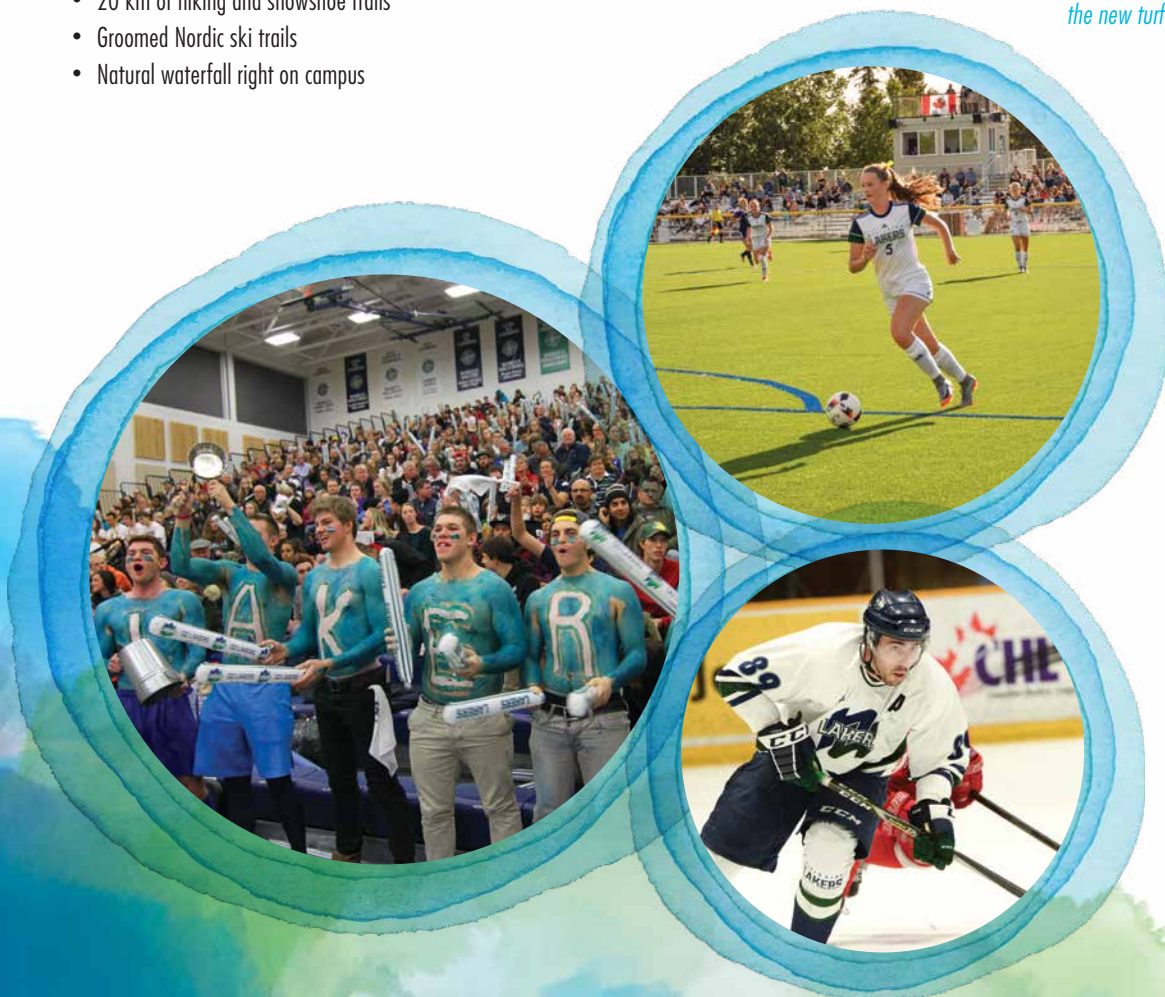

For more details, visit
nulakers.ca

Sports Teams

For a complete list of sports, and details on how to register, visit nulakers.ca

Intramural Sports

Exercise and healthy competition always help to clear the mind. Nipissing's Athletics Department offers a wide range of intramural activities to keep you on your game. Teams include:

- Basketball
- Dodgeball
- Flag Football
- Hockey
- Slo-Pitch
- Soccer
- Volleyball
- Ultimate Frisbee

Club Sports

Club sports are available to all Nipissing students and are both recreational and competitive.

- Cheerleading
- Men's Lacrosse
- Women's Ringette
- Dance Pak

Varsity Teams

Go Lakers! Our varsity athletes always bring their A-game. Get your friends together and come out to cheer on your favourite teams.

We have both men's and women's varsity teams competing at the OUA level in:

- Basketball
- Cross-country Running
- Hockey
- Nordic Skiing
- Rowing
- Soccer
- Volleyball

Nipissing Lakers
hosted the
**2019 OUA
Nordic Skiing
Championships**
on campus

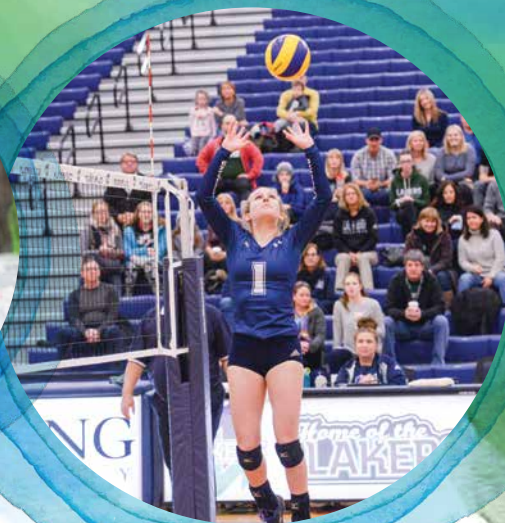

Home of the
LAKERS

Residence

nipissingu.ca/residence

Transfer and mature students may apply to live in residence and will be considered based on space availability. Our residences are rated some of the finest and most modern in Canada with residence options where studying, socializing, living independently, meeting new friends and making your own choices will provide opportunities for many great experiences. In addition, you will have the added comfort of a room of your own.

The campus has both suite-style and townhouse-style accommodations. The townhouse-style accommodation is usually reserved for 2nd year students and up, and is open to mature and transfer students. The residence staff and Residents' Councils organize a variety of fun events to suit all interests such as group dinners and potluck suppers, skating parties, the winter carnival, athletic events, movie nights and coffee houses.

#1 in
RESIDENCE LIVING

among universities
in Canada
– *Maclean's* 2019

TOP FIVE
STUDENT LIFE STAFF
in Canada
– *Maclean's* 2019



grocery bus service for students in residence



stress relief: therapy dogs visit weekly



Suite-style residence (sample layout)

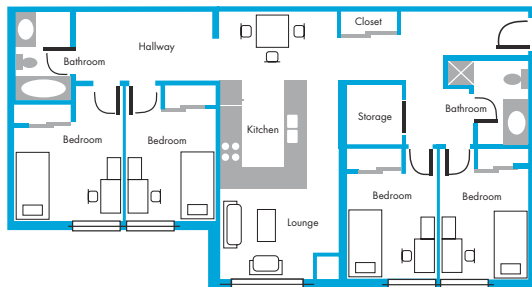

Townhouse-style residence (sample layout)

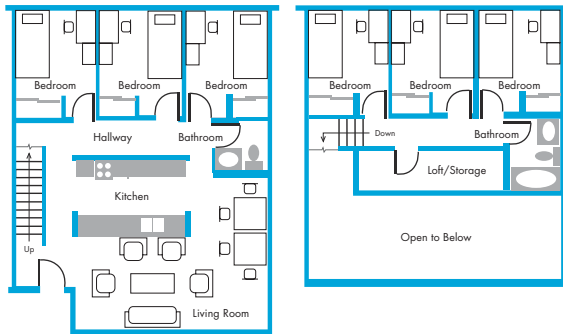

Off Campus Living

Email: offcampusliving@nipissingu.ca
ocl.nipissingu.ca

Off Campus Living is a program designed to assist students with sourcing housing off campus and is a point of contact for students who are in need of resources to help with everyday living in the community. Visit ocl.nipissingu.ca to search housing listings or for more information and tips on renting an apartment or house.

Finance Your Education

Awards and Bursaries

Thanks to the generous funding provided by award donors, Nipissing University is able to provide additional funding to students on the basis of a range of criteria – academic merit, financial need, or a combination of extracurricular involvement, academics, demonstrated leadership ability, or volunteerism.

Once you're a Nipissing student, you just need to complete an application in October of your first year to be considered for all of the upper year funding available. If you think you might have a financial shortfall, apply – you might just get some extra funding!

Automatic Upper Year Carl Sanders Scholarships

Students qualify for the guaranteed upper year scholarships on the basis of their overall average on the top 24 credits taken at Nipissing in the previous fall/winter session. Scholarships are paid out in the subsequent year, as long as the student is registered in at least 18 credits. The scholarships may be held for a maximum of four years.

Automatic consideration after one year at Nipissing

Nipissing GPA in previous fall/winter	Annual Award
90%+	\$1000
85-89%	\$750
80-84%	\$500

For a complete list of scholarships, awards, bursaries, and other funding options, visit nipissingu.ca/bursaries

Other Financial Sources

- Apply for Government Grants and Loans (OSAP): ontario.ca/OSAP

NUWork: On-campus Work Study Program

Nipissing University offers a Work Study program that enables students to work part-time on campus. The majority of positions begin in September so students are encouraged to apply in August. It is expected that students will have explored all possible funding options, including OSAP, before applying for this program. Find applications and more information at nipissingu.ca/nuwork

Student tip: Earn up to
\$1800
with a NUWork
on-campus job.

To qualify, you need to demonstrate financial need, so tap into funding sources like OSAP (even if you don't receive or accept it.)

Create a financial plan

A plan helps you achieve your goals on time and on budget. This information is provided for guidance only. These are estimated based on 2019-2020 costs of living on campus for the 8-month academic term and are subject to change from year to year.

Visit our online calculator for tuition and living expenses:
**nipissingu.ca/
tuition**

Studying in North Bay	Living in Residence	Living Off Campus	International Student Fees
Tuition	\$6,423 – \$8,084	\$6,423 – \$8,084	\$19,325
Ancillary Fees (includes a City of North Bay transit pass)	\$1,368	\$1,368	\$1,992
Housing	\$5,717 – \$6,425 [†]	\$6,000 – \$9,000 [‡]	\$5,717 – \$6,425 [†]
Food	\$2,600*	\$1,920	\$2,600*
Books and Supplies	\$500 – \$1,000	\$500 – \$1,000	\$500 – \$1,000
Personal (does not include travel home)	\$1,700	\$1,700	\$1,700
Total	\$18,308 – \$21,177	\$17,911 – \$23,072	\$31,834 – \$33,042

* Meal plan included in above cost for example purposes is \$1100/term, plus an estimated \$400 for weekend eating out or groceries.

† Does not include refundable \$100 damage deposit.

‡ Off-campus housing costs are estimated based on a 12-month lease.

- Optional on-campus parking (depending on lot): \$161 – \$255

Optional Meal Plans

Optional meal plans are available to all students.

Annual Plan	\$2200	Valid until the end of the school year	Tax-free purchases (save 13%) + 5% discount
Semester Plan	\$1100	Valid until the end of the school year	Tax-free purchases (save 13%) + 5% discount
Swipe & Save Reloadable	Minimum \$100	No expiration	5% discount

For full details visit dineoncampus.ca/nipissingcanadore



Campus Map

Check out our
interactive map
with virtual tours
and photos:
map.nipissingu.ca



- 1 Main Campus
- 2 Harris Learning Library
- 3 R.J. Surtees
Student Athletics Centre
- 4 Governors Residence
- 5 Townhouse Residence
Complex (TRC)
- 6 Founders Residence
- 7 Chancellors Residence
- 8 Monastery Hall (Fine Arts)
- 9 Path to 20 km of trails
- 10 Turf Field
- 11 New Student Centre, Opening 2020

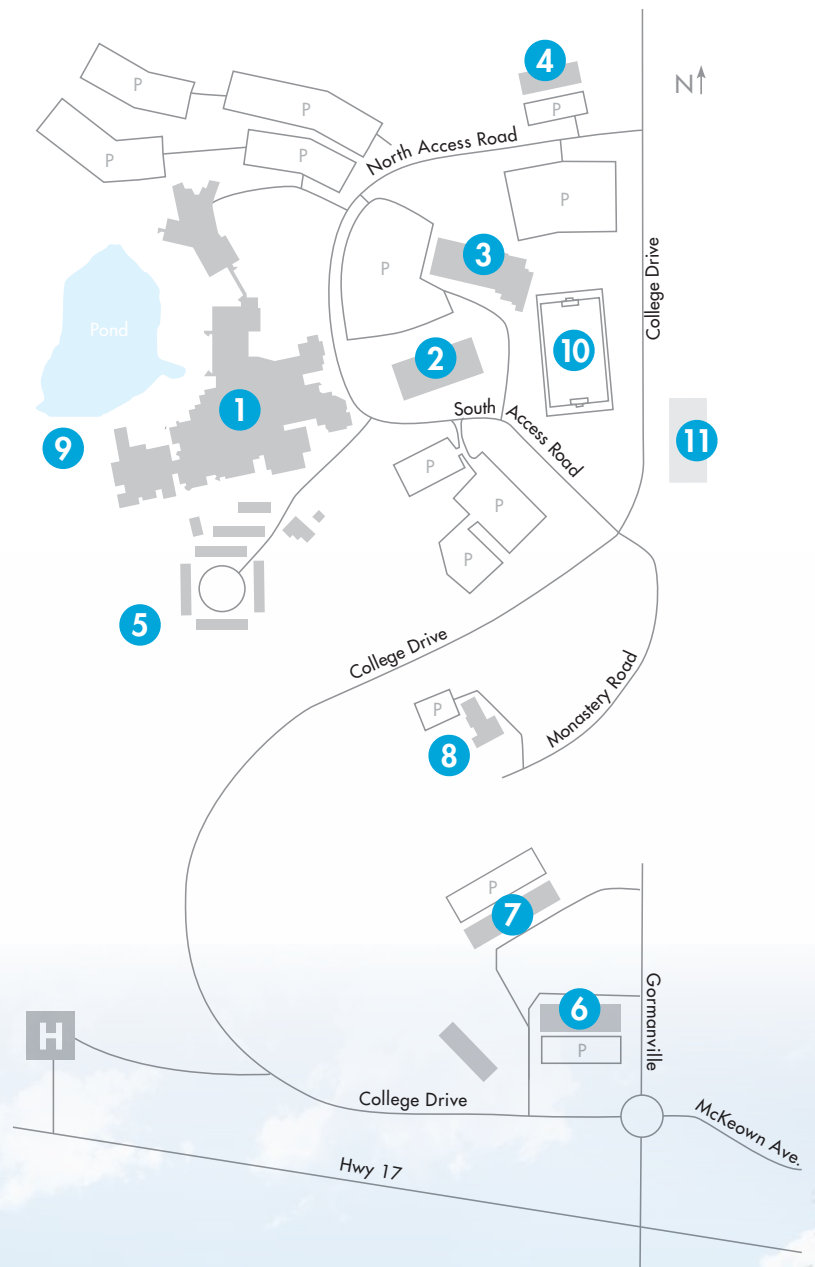

Programs of Study



We have a variety of options to structure and customize your degree. For a full list of program offerings, please visit nipissingu.ca/programs

Undergraduate programs

- Anthropology
- Biology
- Business
 - Concentrations in: Accounting, Business Analytics and Technology, Entrepreneurship and Innovation Leadership, Finance, Human Resources, International Business, Marketing, Public Administration, Sustainable Development
- Child and Family Studies
- Classical Studies
- Commerce (*available online; as a Dual Degree with a BA or BSc on campus; or at a College Partner campus. Visit nipissingu.ca/business for details.*)
- Computer Science
- Criminal Justice
 - Streams in: Corrections, Criminal Justice Studies, Criminology, Legal Studies and Administration*, and Policing
- Economics
- English Studies
- Environment and Physical Geography
- Environmental Biology and Technology
- Environmental Geography
- Fine Arts
- Gender Equality and Social Justice
- Geography
- History
- Liberal Arts
- Liberal Science
- Mathematics
- Native Studies
- Nursing (*available full-time on campus; distance part-time; or in Toronto full-time as a second degree for university graduates. Visit nipissingu.ca/nursing for details.*)
- Philosophy
- Physical and Health Education
- Political Science
- Psychology
- Religions and Cultures
- Social Welfare and Social Development
- Social Work
- Sociology

** Legal Studies and Administration stream is available to students with a diploma in a Law Clerk program from an Ontario Community College*

Dual Degrees

Bachelor of Commerce Dual Degree

If you would like to combine Business with an Arts or Science program, Nipissing offers you the opportunity to study both and complete a Bachelor of Arts or Bachelor of Science degree with a Bachelor of Commerce degree in as little as five years. This dual degree allows you to study a wider range of general interest and career specific subjects. For more information on getting a dual degree, please contact the Recruitment Office at nuinfo@nipissingu.ca or call (705) 474-3450 ext. 4200.

Concurrent Education

Nipissing offers a 6 year concurrent program that leads to you earning both an honours undergraduate degree in your discipline of choice (except Nursing and Social Work), and a Bachelor of Education degree. For further details see page 24 or visit nipissingu.ca/concurrent

Professional and Post-Graduate Programs

- Bachelor of Education (Concurrent and Consecutive)
- Bachelor of Science in Nursing — Scholarship Practitioner Program
- Bachelor of Social Work
- Master of Arts (History)
- Master of Arts (Sociology)
- Master of Education
- Master of Environmental Science
- Master of Environmental Studies
- Master of Science (Kinesiology)
- Master of Science (Mathematics)
- PhD in Education with a focus on Educational Sustainability

Post-Baccalaureate Certificates and Diplomas

- Post-Baccalaureate Certificate in Human Resource Management
- Post-Baccalaureate Certificate in General Management
- Post-Baccalaureate Diploma in Business Administration
- Post-Baccalaureate Diploma in Finance
- Post-Baccalaureate Diploma in Human Resource Management
- Post-Baccalaureate Diploma in International Business
- Post-Baccalaureate Diploma in Marketing

No specific degree or major is required for Law, Medical, MBA, or Veterinary schools.

Nipissing University offers all prerequisite courses required for admission to these programs.



Other Pathways to a Degree

Indigenous Foundations Program

Email: indigenousprograms@nipissingu.ca
nipissingu.ca/indigenous

This full-time, first year transition-to-university program is designed for Indigenous students who are planning to pursue an undergraduate degree and want access to cultural, personal, and/or academic resources.

Students who are transitioning from high school, upgrading, entering from a college program, or who have simply taken a break from their studies are eligible to apply to the program.

Students are part of a community of peers, staff, faculty and Elders while obtaining 24 credits toward a university degree in pre-selected courses for IFP students, and will:

- learn alongside other Indigenous students;
- attend orientation week to meet the professors and other students in the program;
- become more familiar with the university system; and
- gain confidence to be successful at university.

To apply to the Indigenous Foundations Program, prospective students can find the printable application form at nipissingu.ca/indigenous

For more information, please contact the Student Success and Development Coordinator at indigenousprograms@nipissingu.ca



First Year Foundations Program

This program is intended for students who have faced challenges in an academic environment and do not meet the 70% admissions average. Students begin their education journey with a reduced course load and additional support from our services team. Our staff and full-time faculty offer workshops to enhance academic skills and curriculum to support personal development. This strong foundation provides tools and strategies for continued success at Nipissing and offers a smooth transition into the second year of a qualifying degree program. Upon successful completion of first year, students will have earned up to 24 credits. For information visit: nipissingu.ca/fyf

Learn by Doing

Experiential Learning at NU

Experiential Learning provides students with hands-on learning experiences and the opportunity to relate these to their academic interests. Students will develop knowledge, skills, and values from direct experiences outside a traditional academic setting. Experiential learning encompasses a variety of activities including undergraduate research, studying abroad, and other creative and professional work experiences. The results are seen in uniquely employable graduates who are not only ready for the workforce, but ready to lead.

Over 350 North Bay and Regional Community Partnerships

Experiential learning opportunities in many cases are built right into the curriculum as placements and directly engage students in a wide variety of practical, hands-on experiences outside the classroom. Multiple programs offer volunteer learn-by-doing opportunities that develop competencies in communication, critical thinking, collaboration, problem solving and leadership through integrated course-work placements, professional internships, co-ops and practicums.

Biidaaban Community Service-Learning (BCSL)

Biidaaban Community Service-Learning (BCSL) is a unique experiential learning program in which students volunteer for placements within community organizations and apply classroom theory to real-world experiences. A specialized focus is placed on supporting Indigenous youth through Biidaaban Youth Groups and Biidaaban Academic Support programs. Participants receive training from Elders, Indigenous Knowledge Holders, faculty, educators, and community members prior to engaging with community. Biidaaban is an Anishnaabe word meaning “the point at which the light touches the earth at the break of dawn.”

iLEAD Business Experience Certificate, Expeditions, and Co-op

The successful completion of the iLEAD Business Experience Certificate is verification that students have taken advantage of the opportunity to learn through experience, action and discovery. The certificate is earned through successful completion of 15 specific Business credits. As students earn credits toward their degree, courses offer practical, hands-on experience through directed study, workplace internships, overseas study and volunteer service to others.

The Schulich School of Education

The Schulich School of Education at Nipissing University is a recognized leader in the field of teacher education. Earn your Bachelor of Education (BEd) degree in one of the pre-eminent education programs in Ontario. Renowned for graduating exceedingly well-prepared and professionally-minded teachers, the Schulich School will prepare you for teaching in traditional and non-traditional environments, and will provide you with transferable communication and collaborative skills that are essential to any career.

With a history of well over 100 years of teacher education, combined with a rigorous offering of professional learning opportunities, the Schulich School of Education immerses teacher candidates in a series of experiential learning opportunities that range from the integration of digital technology in the classroom, to national and international experiences, to polishing résumés and interview techniques prior to the annual education career fair. Schulich School of Education graduates maintain a distinct reputation as leading-edge and professional educators.

Consider one of two ways to earn your teaching certification: the Concurrent or the Consecutive program.



Pursuing a Degree in Education

	Concurrent Bachelor of Education	Consecutive Bachelor of Education
Description	Students graduate with a Dual Degree – an honours undergraduate degree in their discipline of choice (except Nursing and Social Work) and a Bachelor of Education degree.	A program for those students who already have a completed 3 or 4 year undergraduate degree from Nipissing or another university.
Duration	6 years	2 years (following an undergraduate degree)
Practicum	19 weeks of practicum + 60 hours of Community Leadership Experience (CLE) English Public school boards, English Separate school boards, and First Nations or federally administered schools	19 weeks of practicum + 60 hours of Community Leadership Experience (CLE) English Public school boards, English Separate school boards, and First Nations or federally administered schools
Division	Choose one of the following: P/J – (J/K to Grade 6) P/J – French as a Second Language J/I – (Grades 4 to 10) I/S – (Grades 7 to 12)	Choose one of the following: P/J – (J/K to Grade 6) P/J – French as a Second Language J/I – (Grades 4 to 10) I/S – (Grades 7 to 12)
How to Apply	Apply through ouac.on.ca Current Ontario High School Applicants: Deadline Jan 15, 2020 All other Applicants: Deadline April 1, 2020	Apply through ouac.on.ca by Dec 1, 2019

P/J =Primary/Junior J/I = Junior/Intermediate I/S = Intermediate/Senior

Degree/Diploma Programs in Education

For more information about our summer diploma programs, including admission requirements, tuition, family support, deadlines, and the application process, please visit nipissingu.ca/indigenousprograms

Indigenous Teacher Education Program (ITEP) Degree/Diploma

The Indigenous Teacher Education Program (ITEP) Degree/Diploma program is available for individuals of Indigenous ancestry. You are eligible if you have successfully completed one of the following from an accredited university or college:

- An undergraduate degree
- Early Childhood Education (ECE)
- Indigenous Classroom Assistant Diploma Program (ICADP)
(formerly Aboriginal/Native Classroom Assistant Diploma Program (ACADP/NCADP))
- Native Language Teaching Certificate (NLTC)

This summer intensive program prepares individuals to develop teaching strategies, technological skills, and curriculum knowledge within an indigenous worldview. The program's structure allows working professionals to attend classes in the summer and to return to employment during the academic year. Upon completion, successful applicants will earn a Certificate of Qualification from the Ontario College of Teachers in the Primary/Junior Divisions.

Indigenous Classroom Assistant Diploma Program (ICADP)

The Indigenous Classroom Assistant Diploma Program (ICADP) offers its candidates the opportunity to explore the role of the classroom assistant who works with Indigenous children in elementary public and First Nation schools.

Students explore culturally relevant pedagogical understandings in working with elementary students of all academic levels in numerous subject areas.

Practicum experiences allow students to connect educational theory with practical applications in the classroom and the entire school. Our graduates return to their classrooms with newly acquired skills and knowledge gained from the Indigenous Classroom Assistant Diploma Program to assist Indigenous children in elementary classrooms across the province.

Students in the summer diploma programs are invited to bring their families with them into residence

Youth Experience Programs and a Science Exploration daycamp are available to children of students in a summer diploma program



Teacher of Indigenous Language as a Second Language (TILSL) Degree/Diploma

The TILSL Program provides students who are fluent in the languages of Anishnaabemwin, Cree, Ojibwa, Mohawk and Cayuga the opportunity to earn a Diploma in Education from Nipissing University and a Certificate of Qualification and Registration from the Ontario College of Teachers. You will acquire a thorough understanding of new technologies as well as necessary strategies to deliver Indigenous traditional teachings and Indigenous languages as a subject within First Nation and Ontario public schools from Kindergarten to grade 12. The program's structure allows working professionals to attend classes in the summer and to return to employment during the academic year.



Applying to Nipissing

How to Apply, Application Deadlines and Course Prerequisites

How to apply:	September Entry	January, Spring/Summer Entry
Full-Time	105 application ouac.on.ca	nipissingu.ca/registrarforms
Part-Time	nipissingu.ca/registrarforms	

Full-Time vs Part-Time

- Full-time allows a student to register for the maximum number of courses per term (ie. 5 courses in each of the Fall and Winter terms)
- Part-time reduces the number of courses a student can register for each term (maximum 4 courses/12 credits per term)
- Part-time allows a student to study at their own pace by taking one or two courses each term
- Not all programs are available on a part-time basis

Not sure whether to apply for full-time or part-time studies? Why not choose full-time! This will give you the flexibility to choose how many courses to register in; from one course all the way to the maximum available for the term you were admitted to.

Questions? Contact the Student Recruitment Office at nuinfo@nipissingu.ca or call (705) 474-3450 ext. 4200



Applicants with Post-Secondary Studies

Transferring from University

Applicants who are attending or have attended another university may be considered for admission to Nipissing University with transfer credit for courses already completed. Specific subject requirements for particular degrees must be met through prior grade 12 studies or equivalent courses at the university level. Please visit www.nipissingu.ca/admissionschart or contact the Admissions Office for further details. Admission to some programs is highly competitive and admission is selective, therefore, meeting the minimum requirements will not guarantee admission to certain programs.

Minimum grade for course transfer	Transfer credits	Non-transferable credits
60%	Transfer credit is assessed on a case by case basis. Attempts will be made to provide specific course equivalencies. If a specific equivalence to a course is not available, Nipissing will attempt to award an unspecified, non-equivalent course.	Transfer credit will not normally be granted for practical or clinical courses taken in specific areas such as Engineering, Education, Dance, etc. Credits for courses taken in the areas of Physical and Health Education or Nursing* may be granted when applied to the same program at Nipissing.
50%	Transfer credit will normally be awarded for a degree credit course provided a grade of "C" or higher was achieved. A course with a grade of "D" may be considered for credit only when there are an equal number of course credits with "B" grades or higher on the same transcript.	

*Applicants seeking advanced standing when admitted to the Bachelor of Science in Nursing program may only receive credit for required courses that have been completed within the last ten (10) years.

Transferring from College

Applicants to Nipissing University who have studied at an Ontario College of Applied Arts and Technology may qualify for admission if they meet the minimum admissions requirements outlined on the next few pages. Specific subject requirements for particular degrees must be met through prior grade 12 studies or equivalent courses at the college level. Meeting the minimum requirements will not guarantee admission to certain programs. Admission to some programs is highly competitive and admission is selective.

Transfer credit will be considered for a course provided a grade of "B" or higher was achieved. A course with a grade of "C" may be considered only when there are an equal number of course equivalents with "A" grades. The granting of transfer credits will vary depending on the degree program and major to which the applicant is admitted. Nipissing University residency requirements apply.

Transferring from College – General Policies

Diploma Completed	Nipissing Degree	Prerequisites	Minimum Admission Average	Transfer Credit
3 year diploma	Any	Dependent on degree program applied to. Visit nipissingu.ca/admissionschart or contact the Admissions Office for further details.	70%	Up to 30 credits (1 year)
2 year diploma (2 years of a 3 year diploma)				Up to 18 credits (0.5 year)
1 year of college or certificate				Up to 9 credits (0.25 year)
Advanced Technology diploma	Bachelor of Business Administration ³	Not applicable	70%	Up to 60 credits (2 years)
	Bachelor of Commerce ⁴			Up to 45 credits (1.5 years)
Advertising and Marketing Communication	Bachelor of Arts (English Studies)	Not applicable	72%	Up to 45 credits (1.5 years)
BTEC Higher National Diploma	Bachelor of Business Administration ³	Not applicable	75 points	Up to 60 credits (2 years)
	Bachelor of Commerce ⁴			Up to 45 credits (1.5 years)
Business (3 year)	Bachelor of Business Administration ³	Not applicable	72%	Up to 60 credits (2 years)
	Bachelor of Commerce (4-year) ⁴			Up to 60 credits (2 years)
	Bachelor of Commerce (3-year) ⁴			Up to 45 credits (1.5 years)
Business (2 year)	Bachelor of Business Administration ³	Not applicable	72%	Up to 42 credits (1.5 years)
	Bachelor of Commerce (4-year) ⁴			Up to 42 credits (1.5 years)
	Bachelor of Commerce (3-year) ⁴			Up to 30 credits (1 year)
Certified Aboriginal Financial Manager	Bachelor of Business Administration ³	Not applicable	65% in each course	Up to 45 credits (1.5 years)
	Bachelor of Commerce ⁴			Up to 30 credits (1 year)

Diploma Completed	Nipissing Degree	Prerequisites	Minimum Admission Average	Transfer Credit
Child and Youth Care	Bachelor of Arts – 4 year (Child and Family Studies)	Not applicable	70%	Up to 60 credits (2 years)
	Bachelor of Arts – 3 year (Child and Family Studies)			Up to 45 credits (1.5 years)
	Bachelor of Social Work ¹			Up to 30 credits (1 year)
Community and Justice Services	Bachelor of Arts (Criminal Justice) – Corrections stream	Not applicable	75%	Up to 45 credits (1.5 years) ²
Developmental Services Worker	Bachelor of Arts	Dependent on degree program applied to. Visit nipissingu.ca/admissionschart or contact the Admissions Office for further details.	70%	Up to 30 credits (1 year)
	Bachelor of Social Work ¹	Not applicable		Up to 30 credits (1 year)
Drug and Alcohol Counsellor	Bachelor of Arts	Dependent on degree program applied to. Visit nipissingu.ca/admissionschart or contact the Admissions Office for further details.	70%	Up to 30 credits (1 year)
Early Childhood Education	Bachelor of Arts		70%	Up to 30 credits (1 year)
Educational Assistant	Bachelor of Arts		70%	Up to 30 credits (1 year)
Fine Arts (3 year)	Bachelor of Fine Arts ⁵	Not applicable	70%	Up to 60 credits (2 years)
	Bachelor of Arts (Fine Arts)			Up to 42 credits (1.5 years)
Fine Arts focused diploma (2 year)	Bachelor of Arts (Fine Arts)	Not applicable	70%	Up to 30 credits (1 year)
Graphic Design	Bachelor of Fine Arts ⁵	Not applicable	70%	Up to 54 credits (1.75 years)
	Bachelor of Arts – Major or Specialization in Fine Arts – Studio stream			

Transferring from College – General Policies (continued)

Diploma Completed	Nipissing Degree	Prerequisites	Minimum Admission Average	Transfer Credit
Indigenous Wellness and Addictions Prevention	Bachelor of Arts	Dependent on degree program applied to. Visit nipissingu.ca/admissionschart or contact the Admissions Office for further details.	70%	Up to 30 credits (1 year)
Law Clerk	Bachelor of Arts (Criminal Justice) – Legal Studies and Administration stream	Not applicable	75%	Up to 45 credits (1.5 years) ²
Mental Health and Addictions Worker	Bachelor of Arts	Dependent on degree program applied to. Visit nipissingu.ca/admissionschart or contact the Admissions Office for further details.	70%	Up to 30 credits (1 year)
	Bachelor of Social Work ¹	Not applicable		
Police Foundations	Bachelor of Arts (Criminal Justice) – Policing stream	Not applicable	75%	Up to 45 credits (1.5 years) ²
Practical Nursing	Bachelor of Science in Nursing – Full-time RPN Bridging program	For graduates of Cambrian College, Canadore College, College Boreal, Confederation College, Northern College, Niagara College and Sault College only. This is a limited enrollment program. The minimum GPA for admission consideration may be higher than the stated minimum. There is only one intake per year (September).	70%	Up to 30 credits (1 year)
	Bachelor of Science in Nursing – Part-time Blended Delivery RPN Bridging program	Applicants must have graduated from an Ontario RPN program, and be a current registered member in good standing with the College of Nurses in Ontario (CNO) as an RPN, and be an employee (with a letter of support) of one Nipissing's partner health care agencies. Visit nipissingu.ca/rpn-bscn for a list of partners. This is a limited enrollment program. The minimum GPA required for admission consideration may be higher than the stated minimum. There are two intakes per year (January and September).	70%	Up to 30 credits (1 year)

Diploma Completed	Nipissing Degree	Prerequisites	Minimum Admission Average	Transfer Credit
Social Service Worker	Bachelor of Arts	Dependent on degree program applied to. Visit nipissingu.ca/admissionschart or contact the Admissions Office for further details.	70%	Up to 30 credits (1 year)
	Bachelor of Social Work ¹	Not applicable	70%	Up to 30 credits (1 year)
	Bachelor of Arts – Honours Specialization or Specialization (Social Welfare and Social Development)			Ranges from 30 credits (1 year) to a maximum of 60 credits (2 years) dependent upon final diploma average
Stage and Screen (3 years)	Bachelor of Arts (English Studies)	Not applicable	72%	Up to 60 credits (2 years)
Stage and Screen (2 year)				Up to 45 credits (1.5 years)

- 1 During Year 2 of the Bachelor of Social Work program, students must apply for admission consideration to the professional years (Years 3 & 4) of the program. Admission to the first or second year of the Bachelor of Social Work program does not guarantee acceptance into the professional years.
- 2 Other programs can be applied to with a 70% average and a maximum of 30 transfer credits granted.
- 3 Admitted BBA students complete their program at Nipissing University in North Bay.
- 4 Admitted BComm students complete their program through one of our college partners or online as an independent learner.
- 5 All students admitted to the BFA are required to successfully complete the BFA Portfolio Assessment the year prior to their final year of study in order to remain in the BFA program. Students who are required to withdraw from the BFA may be eligible to continue in the BA in Fine Arts Major or Specialization program.

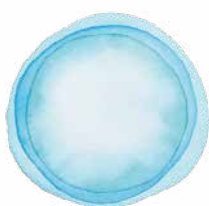

Transferring from College – College Specific Policies

Diploma Completed	Nipissing Degree	Prerequisites	Minimum Admission Average	Transfer Credit
Canadore College				
Biotechnology Technician or Technologist	Bachelor of Science – Honours Specialization or Specialization in Biology	Not applicable	72%	Up to 60 credits (2 years)
	Bachelor of Science – Honours Specialization or Specialization in Environmental Biology and Technology			
Environmental Protection Technician	Bachelor of Science – Honours Specialization or Specialization in Biology			
	Bachelor of Science – Honours Specialization or Specialization in Environmental Biology and Technology			
Strength and Sport Conditioning	Bachelor of Physical and Health Education	Not applicable	72%	Up to 42 credits (1.25 years)
Recreation and Leisure Services				
Recreation Therapy				
Georgian College				
Fine Arts (Advanced)	Bachelor of Fine Arts ¹	Not applicable	70%	Up to 66 credits (2 years)
	Bachelor of Arts (Fine Arts)			Up to 48 credits (1.5 years)
Fine Arts	Bachelor of Fine Arts ¹			Up to 42 credits (1.25 years)



Diploma Completed	Nipissing Degree	Prerequisites	Minimum Admission Average	Transfer Credit
Fleming College (Haliburton School of Art + Design)				
Visual and Creative Arts	Bachelor of Fine Arts ¹	Not applicable	70%	Up to 33 credits (1 year)
	Bachelor of Arts (Fine Arts)			
Humber College				
Computer Engineering Technology	Bachelor of Science – Honours Specialization or Specialization in Computer Science	Not applicable	70%	Up to 60 credits (2 years)
Electromechanical Engineering Technology	Bachelor of Science – Honours Specialization or Specialization in Computer Science			
Toronto Film School				
Fashion Design Film Production Graphic Design and Interactive Media Marketing for Fashion and Entertainment Writing for Film and Television	Any four year Bachelor degree	Dependent on degree program applied to. Visit nipissingu.ca/admissionschart or contact the Admissions Office for further details.	72%	Up to 30 credits (1 year)
	Any three year Bachelor degree			Up to 18 credits (0.5 year)

¹ All students admitted to the BFA are required to successfully complete the BFA Portfolio Assessment the year prior to their final year of study in order to remain in the BFA program. Students who are required to withdraw from the BFA may be eligible to continue in the BA in Fine Arts Major or Specialization program.

Other Transfer Policies

Certified General Accountants of Ontario (CGA)

Applicants to the Bachelor of Commerce or Bachelor of Business Administration programs who have completed specific courses, with a minimum 60% average, through the Certified General Accountants of Ontario (CGA), will be eligible for advanced standing credit. Courses eligible for advanced standing consideration can be found at nipissingu.ca/cgatoarpa

Post-Diploma Accounting Courses

Applicants with post diploma courses in Accounting where a grade of 70% or better has been achieved will be recommended to be granted up to 15 transfer credits. The recommendation will be determined by the director or designate of the School of Business, decided by the Registrar's Office and will be consistent with existing transfer credit practices.

Admission with Transfer Credit

Applicants deemed eligible for admission with transfer credit must submit recently-dated transcripts of their academic record directly to the Office of the Registrar. Applicants presenting transcripts for studies completed outside of North America must have their transcripts assessed (Credential Evaluation Report, including a Course-By-Course Analysis) by World Education Services (WES) — www.wes.org/ca. An Academic Calendar from their former institution(s) containing descriptions of the completed courses may be required. Those applicants who are eligible for transfer credits will be notified of their eligibility. The application of transfer credits to a degree program will vary depending on the degree program and major to which the applicant is admitted. Changing degree programs or majors may mean a loss of or change to the credits awarded. Nipissing University degree residency requirements will apply.

Applicants from Accredited Canadian Colleges

Applicants to Nipissing University who have studied at an accredited Canadian college may qualify for admission to degree programs if they meet the minimum admissions requirements as outlined in the Ontario College of Applied Arts and Technology (CAAT) admission section above.

Bible College Applicants

Applicants from Bible Colleges and similarly religious based institutions that are accredited with the Association for Biblical Higher Education will follow the same policy for admission and advanced standing as for the CAATs.

No credit will be granted for courses in church education or administration, pastoral studies, or courses intended to promote a particular doctrinal or denominational belief.

Mature Student Applicants

Applicants who, according to the Office of the Registrar, do not qualify for undergraduate admission as a regularly qualified applicant may be considered for admission consideration as a mature student if they:

- will be 20 years of age or older by the end of the semester in which they wish to enrol;
- have been away from formal education (secondary school, community college, etc.) for at least the previous two years; and
- are a Canadian citizen or permanent resident.

Mature student applicants to Bachelor of Science degrees or Bachelor of Arts degrees in Computer Science, Economics or Mathematics, must present the 4U or equivalent program specific prerequisites as listed in the Admission Chart in the Academic Calendar.

Mature student applicants to limited enrolment programs (Nursing and Physical and Health Education) are not able to apply for direct entry admission consideration to these programs. Mature student applicants interested in these programs may be admitted to another program and apply for transfer consideration for the following year. For transfer consideration applicants will need to present the 4U or equivalent program specific prerequisites as listed in the Admission Chart in the Academic Calendar.

Mature student applicants are still required to provide transcripts of marks for studies that have been previously completed or undertaken.

Mature students who qualify for admission can be admitted full-time on probation with a reduced course load to a maximum of 24 credits. Upon successful completion of the 18 credits and having cleared academic probation, mature students are eligible for a full 30 credit load status.

International Applicants

Nipissing encourages qualified international applicants currently in Canada or from outside of Canada to consider applying to degree programs at Nipissing University. Interested applicants must apply for admission through the Ontario Universities' Application Centre (OUAC). Applications, the appropriate application fee and the required official documents (transcripts and other documentation) must be received by the Office of the Registrar by April 1 for September admissions consideration. International applicants are not eligible for consideration under Nipissing University's Mature Student Admission Policy. Applicants will be expected to have completed courses in specific academic disciplines depending upon the degree program to which they have applied. International applicants may qualify for transfer credit for previously-completed studies at non-Canadian universities. All international college and university transcripts must be assessed (Credential Evaluation Report, including a Course-By-Course Analysis) by World Education Services – wes.org/ca

Proof of Proficiency in English

All applicants to Nipissing University undergraduate degree programs (excluding BEd) from countries where the dominant language of instruction is other than English are required to demonstrate proficiency in English for admission consideration. Permanent Resident applicants whose first language is not English may be required to provide proof of proficiency in English. Permanent Resident applicants whose first language is not English but who have lived at least three years in Canada, or a country where English is the dominant language may be exempt. Nipissing's full policy including minimum test scores can be found at nipissingu.ca/englishproficiency

Concurrent Education Admission requirements

Transferring from	Minimum Average for admission consideration	Prerequisites
College – ECE diploma	75%	<p>Must be eligible for admission consideration to Nipissing University's Bachelor of Arts (BA) Honours Specialization degree program based on their ECE diploma. Applicants must present:</p> <ul style="list-style-type: none"> • minimum of 70% in one semester of English or Communications at the college level (not Academic and Career Entrance (ACE) Program courses) or ENG4U from high school with a minimum grade of 70% • minimum 60% in one semester of Mathematics (not Academic and Career Entrance (ACE) Program courses or Statistics) at the college level or a 3U or 3M Mathematics from high school with a minimum grade of 60%
College – any program	75%	<p>Applicants must present:</p> <ul style="list-style-type: none"> • minimum of 70% in one semester of English or Communications at the college level (not Academic and Career Entrance (ACE) Program courses) or ENG4U from high school with a minimum grade of 70% • minimum 60% in one semester of Mathematics (not Academic and Career Entrance (ACE) Program courses or Statistics) at the college level or a 3U or 3M Mathematics from high school with a minimum grade of 60%
University	75%	<p>Applicants must present:</p> <ul style="list-style-type: none"> • minimum of 18 credits of undergraduate study, and no more than 72 university credits (including transfer credits) • minimum of 60% in 3U or 3M Mathematics (or equivalent) or a university or college level Mathematics (not Academic and Career Entrance(ACE) Program courses or Statistics) with a minimum grade of 60%
Another Nipissing program (Upper Year Admission)	75%	<p>Application forms are available from the Office of the Registrar and must be submitted by April 1. Applicants must present:</p> <ul style="list-style-type: none"> • minimum of 18 credits of undergraduate study, and no more than 72 university credits (including transfer credits) • minimum of 60% in 3U or 3M Mathematics (or equivalent) or a university or college level Mathematics (not Academic and Career Entrance(ACE) Program courses or Statistics) with a minimum grade of 60%

Application Deadlines

Program	Entry Point	Application Deadline	Document Deadline
FALL ENTRY ONLY PROGRAMS			
Bachelor of Social Work – Professional Years	September	February 1	February 6 (4:30 pm)
Bachelor of Science in Nursing – Scholar Practitioner Program			
Bachelor of Commerce – College Partnership Program	September	August 10	
WINTER AND FALL ENTRY ONLY PROGRAMS			
Bachelor of Science in Nursing – RPN Bridging – Blended Delivery Program	January	October 25	November 1 (4:30 pm)
	September	April 24	May 8 (4:00 pm)
ALL OTHER PROGRAMS			
WINTER	January	December 2	
SPRING/SUMMER	May	April 9	
FALL – FULL-TIME	September	April 1	
FALL – PART-TIME	September	August 10	



Checklist

Check to see that you have your program admission requirements. To be considered for admission, be sure you will have earned all the required and/or recommended courses you need for admission to your program of choice.

○ Attend Fall Open House – November 2, 2019

You are invited! Spend the day with us and meet our faculty, staff and some of your peers. It's a great time to get answers to all of your questions about admissions, programs, and residence life.

○ Apply online

Entry Point	Application
Winter	nipissingu.ca/registrarforms
Spring/Summer	nipissingu.ca/registrarforms
Fall – Full-time	ouac.on.ca
Fall – Part-time	nipissingu.ca/registrarforms

You will receive a confirmation email from Nipissing to confirm receipt of your application.

○ Acknowledgement of your application

After you have applied through OUAC, you will receive an acknowledgement package through the mail from the Office of the Registrar at Nipissing. Packages are mailed and confirm for you that we've received your application and that you are being considered for admission to Nipissing.

○ Send in documents

Nipissing requires official secondary and postsecondary transcripts to be sent directly from the issuing institution.

If applicable, send proof of English proficiency. Some programs require additional documentation. Be sure to read all information sent to you carefully to ensure you don't miss anything or any deadlines.

Check WebAdvisor to ensure receipt of all documentation received.

○ Keep an eye on deadlines

See page 39 for important dates.

○ Check the status of your application

WebAdvisor will show you any change in your application status. It will also help you keep track of any required documents for your application and/or offer of admission. Instructions on how to check your application status and required documents can be found at nipissingu.ca/applicationstatus

- Attend March Open House – March 21, 2020

- Offer of admission sent

Timing of offers will depend on program and entry point applied to. Be sure to read the package carefully. Important information is contained regarding deadlines and next steps. Remember to keep an eye on WebAdvisor. This is the first place you will see a decision made on your application.

- Accept offer of admission

Detailed instructions will be provided in your offer of admission on how to accept your offer.
Be sure to accept by the deadline indicated on your offer.

- Transfer credit assessment

Transfer credit is assessed after you accept your offer of admission. Once completed you will be able to view your transfer credit in WebAdvisor under Unofficial Transcript.

- New Student Orientation (NSO)

Students starting in September attend NSO in July. NSO is a one-day program for all new students and their supporters, including mature and transfer students, who are starting programs in September. This is your opportunity to learn about all of the student academic, health, financial, and housing services available to support your success, and build connections to the Lakers community. You will be contacted directly with an invitation to attend. Child care is provided.

Students starting on-campus programs with a summer or winter entry are connected directly to a Student Experience Coordinator who will identify all of the support services and programs available.

Distance and off-campus students receive notification of available support services and programs through their Program Administrators.

- Register for courses

Information on course registration will be emailed to you.





Approximate
Travel Times to North Bay:

Toronto	3.5 hours
Ottawa	4 hours
Montreal	5.5 hours
Sudbury	1.5 hours

Visit our
campus map:
map.nipissingu.ca

Connect
with us

Open Houses

Fall: Saturday, November 2, 2019

March Break: Saturday, March 21, 2020

For more information and to register for Open House,
visit nipissingu.ca/futurestudents

Book Your Own Campus Tour

Can't make it to an Open House? Come for a tour Monday to Friday at
1 p.m. (except holidays) and some Saturdays in October, November, March
and May. Please register in advance: visit nipissingu.ca/tour, or
call (705) 474-3450 ext. 4200 or email nuinfo@nipissingu.ca

Campus Tour Bursary

Nipissing University offers a bursary for prospective students who travel to visit
our campus in North Bay. For an application form and full eligibility details
visit nipissingu.ca/tourbursary

Questions? Email nuinfo@nipissingu.ca or call (705) 474-3450 ext. 4200.

nipissingu.ca/futurestudents

 facebook.com/NURecruitment

  @NipissingU @NURecruitment



ONE STUDENT AT A TIME

Student Recruitment Office • 100 College Drive, Box 5002, North Bay, ON P1B 8L7

tel: (705) 474-3450 ext. 4200 • toll free (within Ontario): (800) 655-5154

nuinfo@nipissingu.ca • fax: (705) 495-1772 • tty: (877) 688-5507

 facebook.com/NURecruitment •   @NipissingU @NURecruitment

If you would like to request this publication in an alternative format
please contact the External Relations Office at (705) 474-3450 ext. 4078